

2015 State FFA Nursery/Landscape CDE
Architectural Scale Practicum (Five points per question)

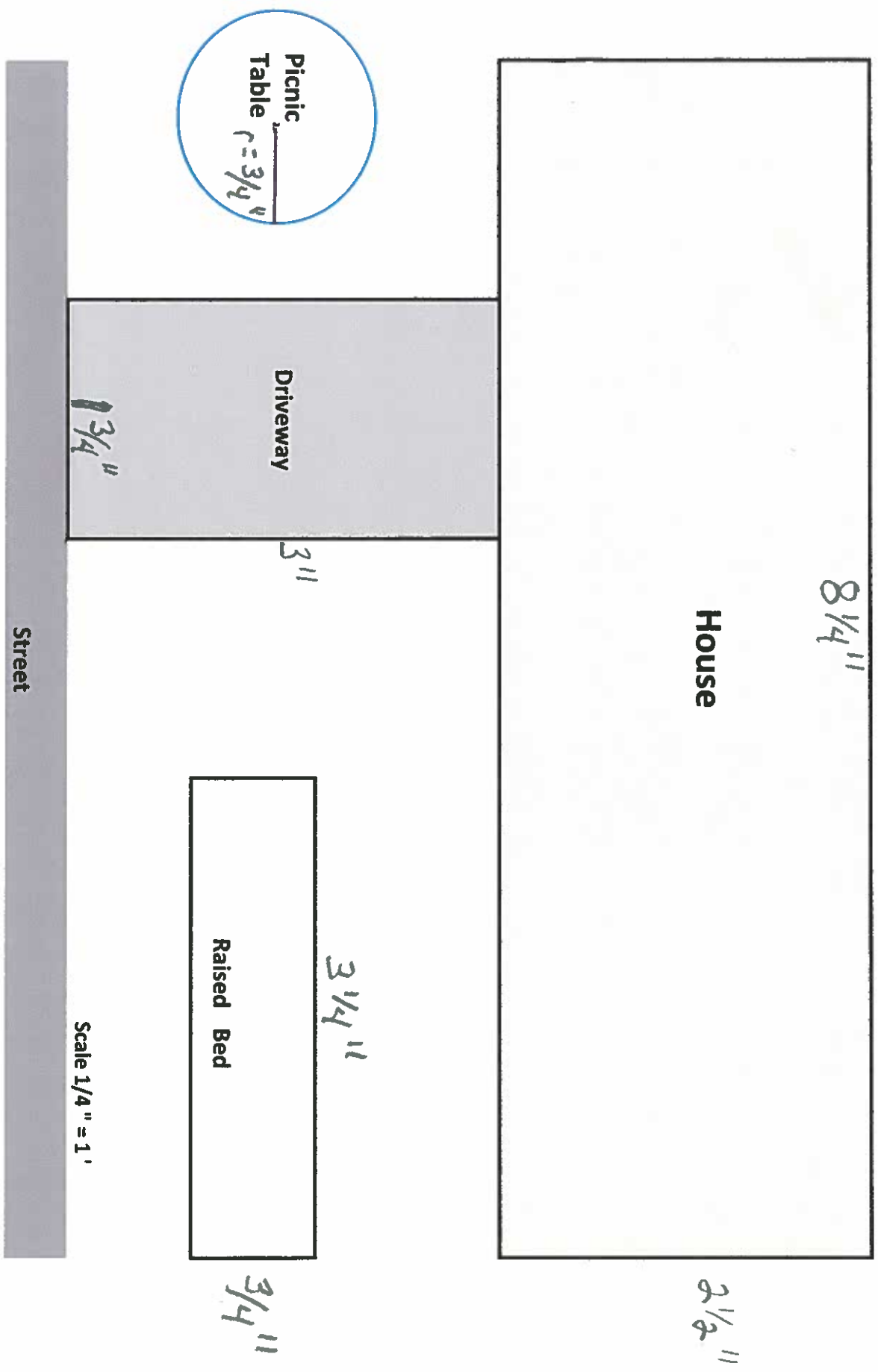

2015 Nursery/Landscape Practicum

Part I Architectural Scale Practicum - 5 points per question (Bubble in answers in the Exam 2/Team section)

1. How many feet wide is the house?
a. 30' b. 33' c. 36' d. 39'
2. How many feet deep is the house?
a. 9' b. 11' c. 13' d. 15'
3. How many square feet of living space is on the first floor?
a. 279 sq.ft. b. 594 sq.ft. c. 891 sq.ft. d. 1,186 sq.ft.
4. How wide is the driveway?
a. 5' b. 7' c. 9' d. 11'
5. How wide is the raised bed? (shortest side)
a. 2' b. 3' c. 5' d. 7'
6. How long is the raised bed? (longest side)
a. 11' b. 13' c. 15' d. 17'
7. How many linear feet of 4" x 4" are needed to make the raised bed one level high?
a. 20' b. 22' c. 24' d. 26'
8. About how many square feet of area is there to plant in the raised bed? (disregard size of timbers)
a. 33 sq.ft. b. 39 sq.ft. c. 42 sq.ft. d. 44 sq.ft.
9. How much edging would be needed along the sides of the driveway? (The two long sides)
a. 16' b. 20' c. 24' d. 28'
10. How much edging is needed around the picnic table foundation (circumference=3.14 x diameter)?
a. 10' b. 16' c. 19' d. 24'

(OVER)

Retaining Wall Practicum Part 2 (Questions are 5 points each)

Answer the questions using the following information as a reference.

1 cubic yard equals 27 cubic feet

Assume loose volume to be the same as compacted volume

2000 pounds in a ton

All wall blocks are \$4.89 each

Sales tax is 7%

Block dimensions: 6" high 16" long 12" deep

Cap dimensions: 4" high 16" long 12" deep

RAISED BED

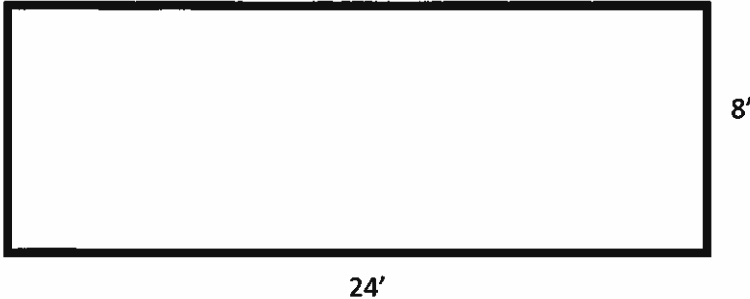

11. How many cubic yards of compactable base (class 2 crushed limestone) are needed for the base? The material will be 6" deep, and 12" wide under the wall.
a. $\frac{3}{4}$ cu.yd. b. $1\frac{1}{4}$ cu.yd. c. $1\frac{3}{4}$ cu.yd. d. $2\frac{1}{4}$ cu.yd.
12. How many blocks are needed for one course?
a. 35 b. 24 c. 48 d. 54
13. Assume one course of block will be buried. How many courses of block will be needed for a one foot wall?
a. 1 b. 2 c. 3 d. 4
14. How many blocks will be needed for the entire project? (no caps)
a. 112 b. 124 c. 132 d. 144
15. If the wall is capped what will the total height be?
a. 12" b. 16" c. 22" d. 28"
16. Not including tax, how much would the blocks and caps cost?
a. \$704.16 b. \$938.88 c. \$1,172.60 d. \$1,407.32

17-20 Total bill for the retaining wall job is Materials \$1,072 and Labor \$500

17. What is the material cost including tax?
a. \$1,072 b. \$1,147.04 c. \$1,367.08 d. \$1,453.16
18. What is the labor cost including tax?
a. \$500 b. \$535 c. \$570 d. \$605
19. What is the total cost of the project?
a. \$1,072.04 b. \$1,647.04 c. \$1,757.06 d. \$1,867.08
20. What is the cost per linear foot of 40' wall?
a. \$31.14 b. \$35.16 c. \$41.18 d. \$46.12

NURSERY/LANDSCAPE PRACTICUM PARTS 1 AND 2 ANSWER KEY

- 1. B**
- 2. A**
- 3. A**
- 4. B**
- 5. B**
- 6. B**
- 7. A**
- 8. B**
- 9. C**
- 10. C**
- 11. B**
- 12. C**
- 13. C**
- 14. D**
- 15. B**
- 16. B**
- 17. B**
- 18. A**
- 19. B**
- 20. C**